



Ultra Bright LED Keyring Light

(Product code: L/H KEYFOB)

BATTERY REPLACEMENT INSTRUCTIONS

For access to the battery compartment unscrew the top cover and remove the metal surround, then unscrew the switchplate to reveal the batteries fitted beneath

When replacing batteries check the polarity is as indicated

Sliding switch ON/OFF

Torch uses 2 lithium CR2016 3V button cell batteries (supplied)

Please note:
LED bulbs are non-replaceable

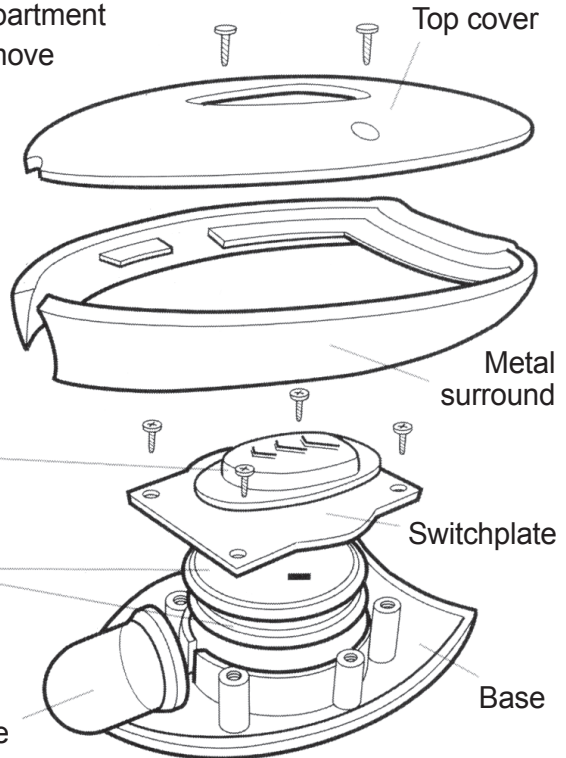

WARNING!

DO NOT LOOK DIRECTLY AT THE LED LIGHT

DO NOT SHINE TORCH DIRECTLY IN THE FACE OF OTHERS